

### Stirling Inline Lever Lever



### Features

- **Stainless steel construction with weight balanced spring cassette**  
Premium feel and consistent 90 degree lever return
- **Manufactured from investment cast grade 316 austenitic stainless steel**  
Ultimate corrosion resistance
- **Wide backplate**  
To suit cylinder guards and accommodate larger cylinder prep.
- **Low friction nylon bush**  
Smooth and consistent operation
- **Screws included to suit 60-70mm profiles**  
Everything needed for installation included in pack
- **Screws and spindle manufactured from grade 304 austenitic stainless steel**  
Excellent corrosion resistance for all parts

### Stirling Inline Lever Lever

#### Ordering Details

##### Product

Stirling Inline Lever Lever

##### Finish

Brushed Steel

##### Part No.

10050

#### Technical Information

##### Corrosion resistance

Conforms to the requirements of BS EN 13724:2002

##### Operation

Tested to 200,000 cycles

##### Performance

Salt spray tested to 1000 hours (BS EN1670: Class 5)

#### Material Specification

Handle Grip and Backplate: Stainless Steel

Coatings: Brushed Steel

Spindle / Screws: Includes screw and spindle pack suitable for 60mm-70mm profiles (1 x 8mm x 120mm grade 304 stainless steel spindle, 2 x M5 x 70mm grade 304 stainless steel machine screws, 2 x M5 x 80mm grade 304 stainless steel machine screws).

#### Packaging

##### Handles

Individually boxed with screws, spindle and care instructions. 15 handles in an outer box.

#### Maintenance

To maintain your stainless steel product in best condition, we recommend routine cleaning once a month. All exposed stainless steel surfaces should be wiped over with a clean cloth and warm water with a mild detergent on a frequent and routine basis. Cleaning should always be immediately followed by rinsing in clean hot water and the surface then wiped completely with a dry towel. For more stubborn dirt or stains use mild, non-scratching abrasive powders such as typical household cleaners. These can be used with bristle brushes, sponges or non-abrasive scourers. For more aggressive cleaning a small amount of vinegar can be added to the powder. Carbon steel brushes and steel wool should be avoided as they may leave particles embedded in the surface, which can lead to rusting.

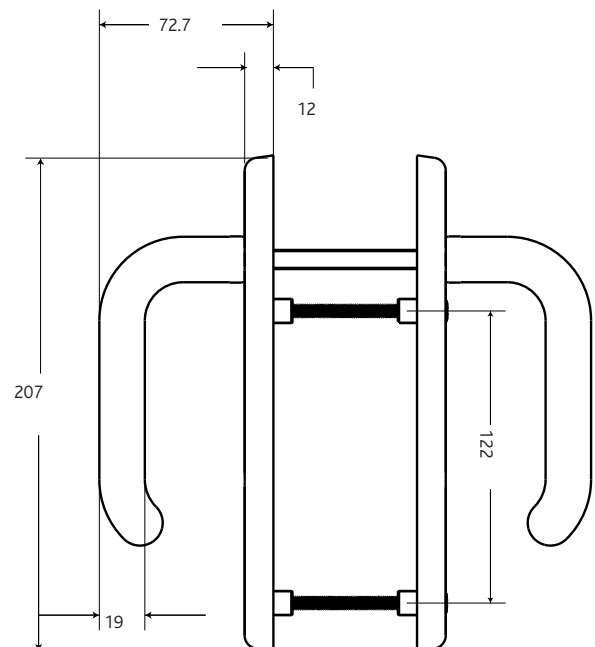
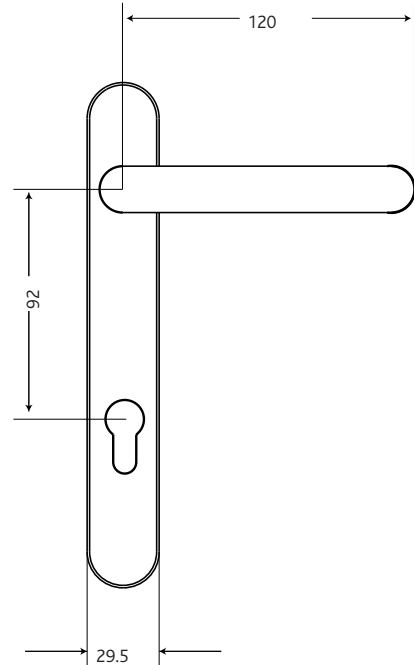

All dimensions are in mm and are nominal.  
 Fab&Fix reserves the right to change specification without notice.  
 It is the responsibility of the door manufacturer to ensure that the finished product meets any required safety and performance specification.