

## Berwick High Security Handle Fitting Instructions

### Berwick High Security Handle

- 1 Please ensure you route the correct size holes in the door to accept the security handle **A**. It's important to use a rule and square to correctly mark out the holes. Check the handle holes are aligned. 44mm and 70mm version of the handle are available, please ensure you have the correct screw and spindle pack for the door installation. The boss length is also different for the 44mm and 70mm versions for different door thicknesses which needs to be prepped for during routing.
- 2 The part of the handle with the smaller cylinder hole is the external handle for the outside of the door and the other half with the standard cylinder hole is for the inside of the door **B**.
- 3 Please ensure the lever is facing in the correct direction at a 90° angle towards the hinges in order to correctly hand the product **C**. When the lever is in the correct position, then insert the spindle into the back of the handle. NB: if the spindle is not inserted into the handle when the lever is in the correct position it may cause the spring cassette in the internal and external handle to clash.
- 4 Once the spindle is inserted the handle can be placed on the door and screwed into place. Please ensure screws are tightly fixed to secure the handle; and to check operation push the lever downwards - it should spring back into place when released.

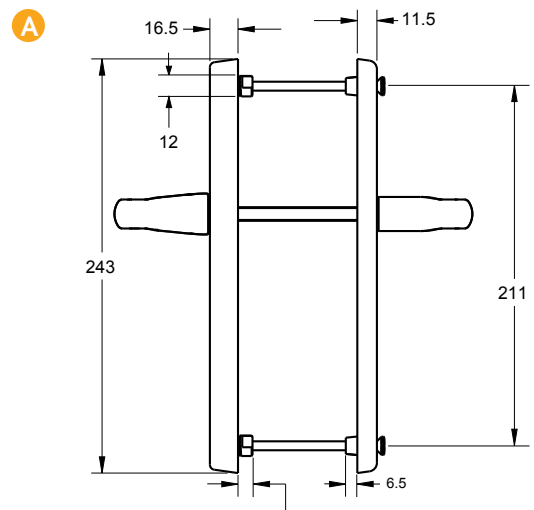

Screw bosses for 44mm version: 8.5  
Screw bosses for 70mm version: 18.5

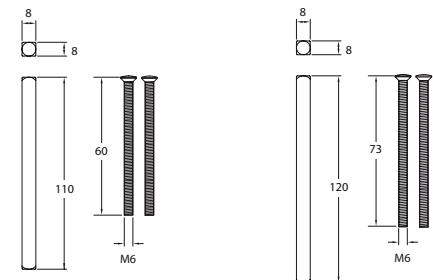

44mm version  
screws and spindle

70mm version  
screws and spindle

